

ENTRY METHOD: RANDOM DRAW

ENTRIES OPEN ON Tuesday, April 26, 2022 at 8:00AM CDT. All entries received before this date will be returned. Overnight or certified mail must be sent with the "No Signature Required" waiver signed. German Shepherd Dog entries will be given priority. **Entries must be received by Tuesday, May 10, 2022 at 5PM CDT to be included in the random draw. Draw will be held on Wednesday, May 11, 2022 at 6PM CDT at the following address: 14151 Vale Court, Eden Prairie, MN 55346-3019.** At the draw, if the number of entries of German Shepherds is less than the overall trial limit, all German Shepherds will be accepted into the trial and the remaining entries will be subject to a draw. If the German Shepherd entries on the draw date exceeds the trial limit, the German Shepherds will be subject to a draw and entries for all other breeds will be shredded.

ENTRIES CLOSE ON Wednesday, June 1, 2022 at 5pm CDT after which time entries cannot be accepted, cancelled, altered, or substituted except as provided for in Chapter 11, Section 6 of the Rules Applying to Dog Shows. Envelopes/transactions containing entries for more than the ten (10) dog maximum and/or entries received prior to the opening date shall be treated as an invalid entry and shall be returned to the sender.



PREMIUM LIST

German Shepherd Dog Club of Minneapolis & St. Paul
(Licensed by the American Kennel Club)



Containers - Interiors – Exteriors –Handler Discrimination (Novice – Master)

Saturday, June 11, 2022 – Event #2022199808 & 2022199809

Sunday, June 12, 2022 – Event #2022199810 & 2022199811

Saturday and Sunday will be run Concurrently

This trial will be held at:
Cannon Valley Fairgrounds
800 N 9th Street
Cannon Falls, MN 55009

ENTRY LIMITS

Saturday & Sunday – 250 for each day
Detective - limit of 10 per trial

To be held Indoors/Outdoors

Trial Hours:

Saturday–7:00am to 5:00pm

Sunday- 7:00am to 5:00pm

Check-in from 7:15am - 7:45am daily Novice & Detective

Novice & Detective Handler's Briefing at 8:00am (or a bit sooner if the last novice and Detective dog are checked in) with first dog to follow

Advanced, Excellent and Master briefing times will be e-mailed after the close of trial.

Judge: Johnnette Ulch – Belle Paine, Iowa

Judge: Sharon Middendorf – St. Paul, Minnesota

Published 04/2022



AMERICAN
KENNEL CLUB

CERTIFICATION

Permission is granted by the American Kennel Club for the holding of this event under American Kennel Club rules and regulations

Gina DiNardo, Secretary

OFFICERS OF THE GREATER GERMAN SHEPHERD DOG CLUB OF MPLS & ST. PAUL

President Bo Vujovich
Vice President Martha Simonett
Secretary Sheila Metz – 320 County Road B West, Roseville, MN 55113
Treasurer Cheryl Carrigan

<http://gsdcmsp.org/home.html>

TRIAL CHAIRPERSON	EVENT SECRETARY
David Mielke 1658 Darlene St St Paul, MN 55119-3006 Davidmielke52@icloud.com 651-756-9650	Ava Higginbotham 14151 Vale Court Eden Prairie, MN 55346-3019 LoveThatDog729@comcast.net 612.209.3589

EVENT COMMITTEE

David Mielke, Melissa McIntyre, Linda Koestler, Laura Newland and Julie Swinland

Judge Assignments:

Johnnette Ulch #102491	Sharon Middendorf #102420
Trial 1 & Trial 2	Trial 1 & Trial 2
Saturday Novice through Master Exterior Handler Discrimination Detective (Trial 1 only)	Saturday Novice through Master Containers Interiors
Sunday Novice through Master Containers Interiors	Sunday Novice through Master Exterior Handler Discrimination Detective (Trial 1 only)

DOGS ELIGIBLE TO ENTER

This trial is open to all dogs SIX (6) months of age or older that are registered with the American Kennel Club or that have AKC Limited Registration. Purebred Alternative Listing/Indefinite Listing Privileges (PAL/ILP), an AKC Canine Partners listing number or approved Foundation Stock Service (FSS) breeds are eligible to participate.

Dogs with a Purebred Alternative Listing/Indefinite Listing Privileges (PAL/ILP) or an AKC Canine Partners listing number must be spayed or neutered in order to compete. Wherever the word “dog” is used in these regulations, it includes both sexes.

Dogs with physical challenges (including amputees) are eligible to participate provided that, in the opinion of the judge, the dog displays no sign of physical discomfort and can safely complete the search. Deaf and blind dogs are allowed to enter. Females in season may not participate. Aggressive dogs, or dogs suffering from an injury or illness which may affect the dog's physical or mental performance, may not participate. No dog shall compete if it is sutured, bandaged, or has any visible wounds.

Artificially colored dogs are NOT permitted to compete in AKC Scent Work.

All exhibitors should obtain a copy of the most current **Regulations for Scent Work Trials** by downloading it from the American Kennel Club website (www.akc.org).

COVID-19 ADVISORY!!

This trial may be canceled at any time due to unforeseen new or renewed COVID-19 restrictions!

If the GSDCMSP Board and Event Committee needs to cancel this event due to changing COVID-19 restrictions, your check will be shredded. There will be no refunds for cancellation once the trial begins on June 11, 2022.

COVID-19 guidelines (subject to change):

- ❖ **STAY HOME if you have been tested positive for COVID-19** within five (5) days of the event or are showing any signs of the illness.
- ❖ Do not carpool with another person unless that person has been free of illness for at least five (5) days
- ❖ It is recommended that you maintain at least six (6) feet between yourself and others during indoor phases of the trial
- ❖ Feel free to wear a mask if it makes you feel more comfortable
- ❖ Spectators will be allowed at the Judge's discretion
- ❖ Volunteer videographers will not be available
- ❖ Since crating will be out of your vehicle, bring what you will need to keep yourself and your dog comfortable
- ❖ Read and understand the latest information provided by the State of Minnesota

Current CDC guidelines for COVID-19 are at <https://www.cdc.gov/coronavirus/2019-ncov/index.html> which has links to local county guidelines. Click the "Learn More" button under "Find Local COVID-19 Guidance" near the top left, and then on the next screen enter "Minnesota" for the state and "Goodhue" for the county. This is where the trial is being held.

By submitting your entry, you agree that you are attending this event at your own risk, you have read and understand the above COVID-19 Advisory, and that you release and hold harmless the AKC, GSDCMSP, Judges, Event Committee, Trial Chairperson, Volunteers, trial Secretary and the Cannon Valley Fairgrounds from any and all loss or expense related to COVID-19



ENTRY FEES PER RUN

Each entry (includes a \$3.50 AKC recording fee)..... **\$25.00 (checks payable to: GSDCMSP)**
Each **Detective** Run (includes a \$3.50 AKC recording fee)..... **\$35.00 (checks payable to: GSDCMSP)**

Mail entry form, release form and fees (checks only) to:

**Ava Higginbotham
C/O GSDCMSP, Trial Secretary
14151 Vale Court
Eden Prairie, MN 55346-3019**

No entries will be accepted by phone, email, fax, or hand delivery. Express mail entries must include the signature waiver allowing them to be left at the secretary's address. Inquiries may be e-mailed to: **Ava Higginbotham** at LoveThatDog729@comcast.net
No entry shall be made, and no entry shall be accepted, which specifies any conditions as to its acceptance. **Illegible entries** will not be processed and will be returned to the exhibitor. Returned checks do not constitute a valid entry. The Event Secretary will add a \$35.00 collection fee to the amount of each returned check.

VOLUNTEERS HAVE PRIORITY ENTRY

Volunteers numbering 20 will have priority entry into the trial. To volunteer and have priority entry into the trial, you must be able to work for ½ of the day. If you volunteer after the random draw cutoff date May 10, 2022 you will not be guaranteed a priority entry. **Lunch is provided free to all volunteers. Write the word VOLUNTEER on the outside of your envelope to make sure you get in before the draw.**

To volunteer, please contact: Laura Newland at: laurasmora101@gmail.com

WAITLIST INFORMATION

All entries must be received by the Trial Secretary prior to Wednesday, June 1, 2022 at 5pm CDT. **No entries may be withdrawn for a complete refund after closing on Wednesday June 1, 2022 at 5pm CDT** unless withdrawn entries are filled as follows: **GSDCMSP** is offering a waitlist to fill openings created by entries that have been withdrawn after the trial's closing date/time. A maximum of **50 runs per day** will be placed on the club's waitlist. If runs of a withdrawn entry are replaced by waitlisted runs, a refund will be issued to the exhibitor of the withdrawn entry for those runs just filled. Exhibitors who were able to have some runs filled, but not all, will receive a refund at the end of the trial for those runs that did not have openings. Checks will be shredded for any exhibitors who were unable to have any of the runs requested on the entry.

REFUNDS

No entry fee will be refunded if the trial cannot open or be completed by reason of riots, civil disturbances, fire, an act of God, public emergency, act of a public enemy, or any other cause beyond the control of the organizing committee. No entry fee will be refunded in the event a dog is absent, disqualified, excused, or barred from competition by the action of the Event Committee. **Dogs pulled after closing because of injury or other medical condition** are eligible for a full refund contingent on the Trial Secretary receiving verification of injury or illness by a qualified veterinarian no later than 24 hours before each trial starts.

Bitches in season will be refunded the full entry fee. Notification in writing must be given to the trial secretary no later than one half hour prior to the start of the first class of the day of the trial.

MOVE-UP INFORMATION

Move-ups are allowed between Saturday and Sunday only but, move-ups **WILL NOT** be allowed between trial 1 and trial 2. Move up forms must be turned into the trial secretary before you leave the trial site on Saturday. No move ups will be allowed on Sunday. **Move ups are only allowed if that judge has not reached their judging limit for the day.**

SITE INFORMATION

STAGING AREA, HANDLER'S BRIEFING, AND WARM-UP INFORMATION

Staging Area will be out of view of search area(s). Staging area will include crating, warm-up and waiting area, as well as the secretary table for check-ins and posting of running order and results. There will be **no inside crating**.

The **Handler's Briefing** will take place in view of the search area prior to the start of each class, after the hide(s) have been set and after the Demo Dog has run. In the Handler's Briefing the judge will explain if there is an off-leash option, number of hides, maximum height of hides and maximum time for the search. NO DOGS are to be present during the Handler's Briefing.

A **Warm-up Area** will be available consisting of ONE marked container of each odor being tested at the trial and may also consist of blank containers. Exhibitors should limit their warm-up to (2) two minutes or less. The warm-up area is to be used exclusively for warming up the handler-dog team prior to their run. The warm-up area is not for training or relieving of the dog. No handling teams are allowed in the warm-up area unless they are practicing just before they are called for their search.

SEARCH AREA AND RING CONDITIONS

Search areas may be of any shape, and of the size specified in the Regulations for AKC Scent Work for each class.

Search Area Conditions. Searches may be indoors, on matted, carpeted, or tiled surfaces, or outdoors on grass, gravel, earth, concrete, or asphalt surfaces in accordance with AKC Scent Work regulations.

CANNON VALLEY FAIRGROUNDS SITE SPECIFICS ADDITIONAL SITE INFORMATION

Trial Site. It is not appropriate to scout the trial location prior to the trial date. Many search locations are real-life environments, and such visits may risk the host losing the opportunity to use the location in the future.

Possession of Odors and Training. Chapter 5. Section 35 of the Scent Work Regulations state “No person other than those engaged in the administration of a trial shall be in possession of any target odor when on the trial grounds. There shall be no training on the grounds of the AKC Scent Work trial, other than the designated warm-up area.”

Spectator Area. Spectators are encouraged. Any person not handling a dog in the current class, or any person who has already completed their run in the class may choose to watch the search from the spectator area. Handlers may not watch other exhibitors from their class prior to their run except in the case of Handler Discrimination classes. No one outside the search area may assist the handler or disclose the location of the hide. Spectators who intentionally or unintentionally give aid to a team may be asked to leave the area by the judge. Spectators are forbidden to discuss details of the search with handlers who have not run.

RIBBONS, AWARDS, AND PRIZES

Placement ribbons will be awarded in each class as follows:

<i>First Place</i>	<i>Blue</i>
<i>Second Place</i>	<i>Red</i>
<i>Third Place</i>	<i>Yellow</i>
<i>Fourth Place</i>	<i>White</i>
<i>Qualifying Score</i>	<i>Dark Green</i>

A **New Title rosette** will be awarded to all dog and handler teams who finish an Element or Level title.

A **High in Trial rosette** will be awarded to all dog and handler teams who qualify with the least number of faults (and fastest time, if a tie) of a particular difficulty level of all elements (for example, novice containers, novice interiors, novice exteriors) The High in Trial award does not take into account Handler Discrimination classes.

A **High Combined Division (HCD) rosette** will be awarded to teams who participate in the same difficulty level in all elements **plus Handler Discrimination** and **qualify in each** (for example, novice containers, novice interiors, novice exteriors, novice handler discrimination).

A **Silver Sniffer Award** will be given to the oldest dog who gets a qualifying score

The **Highest scoring German Shepherd Dog** will win a special award

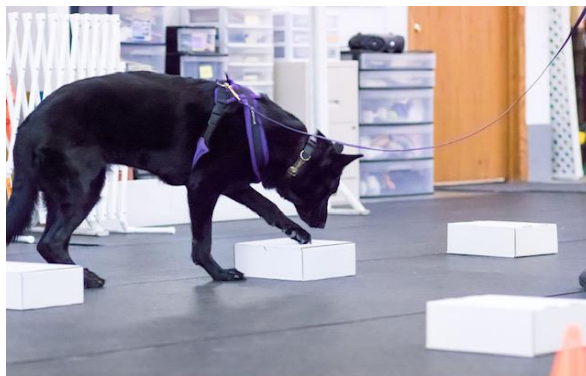

NOTICE TO EXHIBITORS

SAFETY, BEHAVIOR and LIABILITY

The safety of the dog is our primary concern. By entering this trial, exhibitors acknowledge that they are familiar with the rules and regulations of this sport, and that their dogs are familiar with and able to perform all searches safely. **It is expressly understood** that exhibitors alone are responsible for the behavior of their dogs and/or children. Any exhibitor whose dogs and/or children create an unnecessary disturbance or repeatedly engage in unsafe or disruptive behavior may, at the discretion of the Event Committee, be asked to leave the show site. In such case, no refund of any fees paid will be made. The German Shepherd Club of Mpls/St Paul and its agents, employees, etc., will assume no responsibilities for any loss, damage or injury sustained by exhibitors or handlers, or to any of their dogs or property and further assumes no responsibility for injury to children. The German Shepherd Club of Mpls/St Paul reserves the right to decline entries for cause and may remove any dog on account of aggression. No one shall have any recourse or claim against the German Shepherd Club of Mpls/St Paul or any official thereof.

Collars, Leashes and Harnesses. During searches, dogs must wear a properly fitted collar or harness approved by the judge. Leashes may be of any length and/or retractable. The leash should be made of plain, pliable material. Please read Chapter 5 Section 13, page 33 in the rulebook for further information about proper equipment.

All dogs must be on leash at all times. Retractable leashes may not be used when on trial grounds (except during judged searches). Dogs must enter and exit the search area with the leash attached to the collar or harness, including when waiting in the search area before and after the search. An off-leash option may be offered at the discretion of the judge, only if the area is completely enclosed.

Exhibitors are responsible for cleaning up after their dog(s). Any exhibitor failing to do so may be excused without benefit of refund if the Event Committee deems the exhibitor to be in violation of this requirement. Cleaning supplies and disposal sites will be available at various locations around the facility.

RINGSIDE

The Owner of each dog is solely responsible for having it ready at the search area when it is to be judged. The Club has no responsibility to provide service through a public address system or stewards or runners for the purpose of calling or locating dogs that are not brought into the ring when required.

EXHIBITOR CHECK-IN: Once the time and location for check-in is determined all exhibitors will be notified by email.

Exhibitors MUST check-in EACH day they are entered. You will receive a more detailed check-in time when the judging schedule gets posted.

Claims will be arbitrated as set forth on the Official AKC Entry Form for this event.

"Exhibitors should follow their veterinarian's recommendation to assure their dogs are free of internal and external parasites, any communicable diseases, and have appropriate vaccinations." Additionally, clubs should include any specific local or state health requirements, for example, proof of rabies vaccination.

PET FRIENDLY HOTEL INFORMATION

Please check pet policies and fees when making your reservations. Pet fees vary widely and can be per pet per night. Some hotels have only a certain number of pet friendly rooms available. Policies do change, so call the hotel to verify. Please clean up after your dog and do not leave dogs unattended in hotel rooms.

It is advised that you make a refundable reservation, or one that can be easily canceled, as this scent work event may need to be canceled due to COVID-19 restrictions.

GrandStay Hotel – 32027 Alexander Ct – Cannon Falls, MN 55009 (1-507-757-1100)

Fairfield Inn and Suites - 114 2nd Street West – Northfield, MN 55057 (1-507-366-5000)

AmericInn by Wyndham, Northfield – 1320 Bollenbacher Dr – Northfield, MN 55057 (1-507-645-7761)

DIRECTIONS TO THE TRIAL SITE

Best way is to always use your own GPS system

From the West:

494 E to Hwy 52 S (exit #66)
Left on Cty Rd 86/Rochester Blvd
Cty Rd 86 turns into Cty Hwy 29 which then turns into N. Hwy 20/MN 20
Right onto Cty Hwy 17/295th Street
First Left onto 8th street – Stray straight to go to 9th st. Fairgrounds are on your right

From the North:

35E South towards St. Paul
Take US-52/I-94/US-10 exit #107A on the left
Merge onto US 52S
Follow directions above once on 52 S

From the East:

494 W to 52 S – Follow directions from the West

From the South:

35N to Exit 55/Faribault
Straight onto Lyndale Ave/MN 21
Right onto 20th St/MN 3
Left onto 2nd Ave/MN 3 – Follow MN 3
Right onto Cty Hwy 86/Cty Hwy 29
Cty Hwy 29 becomes N Hwy 20/MN 20
Right onto 295th St/Cty Hwy 17
First Left onto 8th Street
Stay Straight to go to 9th St
Fairgrounds on your right

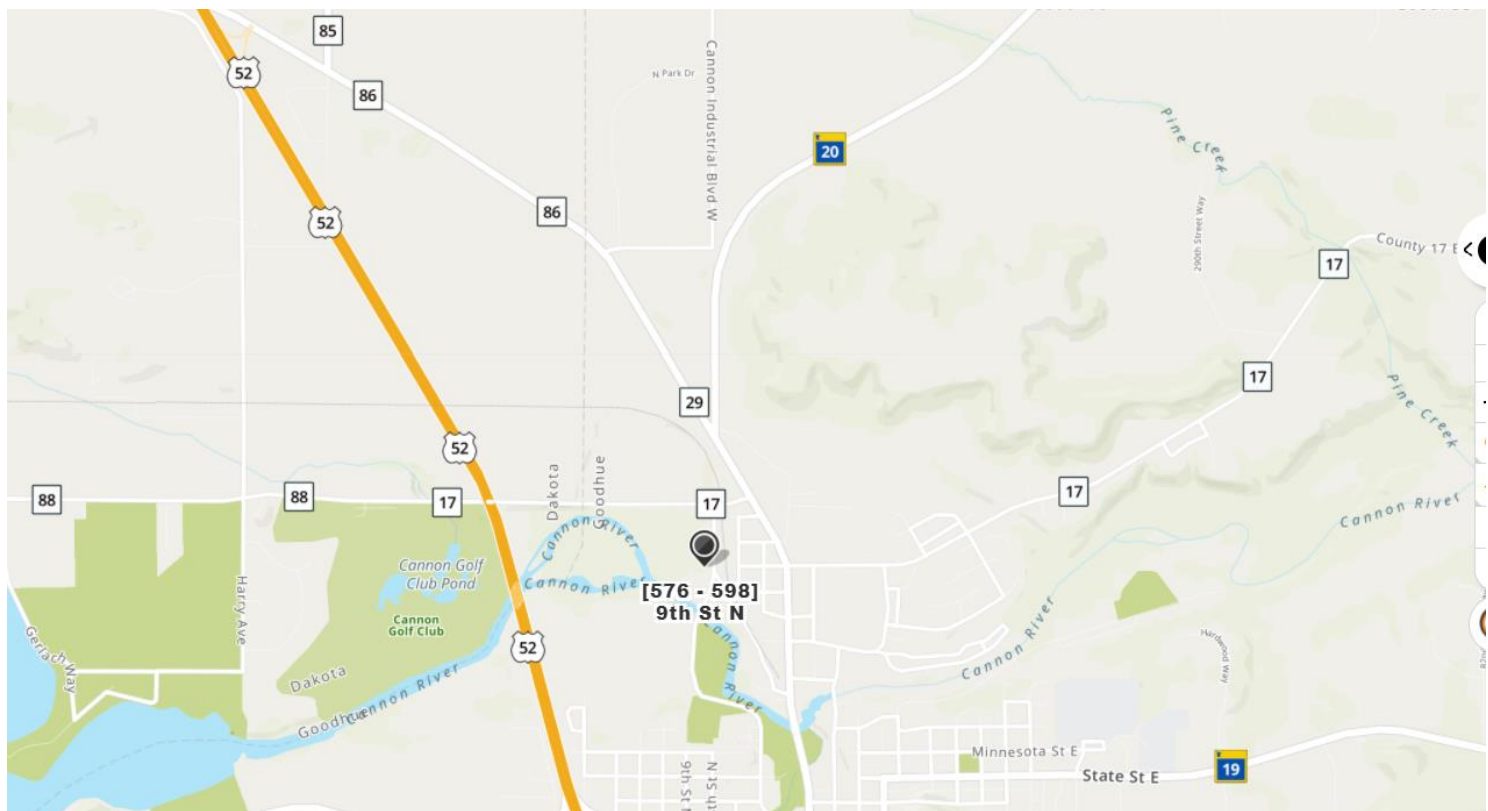

VETERINARIAN ON CALL

South Metro Animal Emergency Clinic
952-953-3737
14690 Pennock Ave
Apple Valley, MN 55124
(Approx. ½ hour drive from site)

Directions to Emergency Vet: Take Hwy 52 N (15.24 miles) to County Hwy 46
Left onto County Hwy 46 – County Hwy 46 becomes 160th St
R. onto Pilot Knob Rd/County Rd 9/County Hwy 31
L onto 150th St/County Hwy 42
R onto Pennock Ave
Vet Clinic is on your Right

EMERGENCY SERVICES

Non-emergency numbers

Fire Department
320 Hoffman St W, Cannon Falls, MN 55009 (507) 263-7027

Police Department
918 River Road, Cannon Falls, MN (507) 263-2278

Emergency call - 911





OFFICIAL ENTRY FORM

ALL FIELDS ARE REQUIRED. Please print legibly.

If you have a PAL/ILP/CP you may put N/A in the lighter shaded boxes.

*****Be sure to read the Agreement (next page) and sign. No form will be processed without your signature!*****

INSTRUCTIONS

Please check the box for each class desired to be entered. Dogs may enter two different levels within each element, at each trial. Dogs entering the Advanced, Excellent, Master or Detective classes must have earned the required title, as stipulated in the AKC Scent Work Regulations. Dogs may enter either the Novice "A" class or the Novice "B" class per element — not both.

	Container	Interior	Exterior	Handler Discrimination	Detective
Trial 1 Saturday 06/11/2022	<input type="checkbox"/> Novice A <input type="checkbox"/> Novice B <input type="checkbox"/> Advanced <input type="checkbox"/> Excellent <input type="checkbox"/> Master	<input type="checkbox"/> Novice A <input type="checkbox"/> Novice B <input type="checkbox"/> Advanced <input type="checkbox"/> Excellent <input type="checkbox"/> Master	<input type="checkbox"/> Novice A <input type="checkbox"/> Novice B <input type="checkbox"/> Advanced <input type="checkbox"/> Excellent <input type="checkbox"/> Master	<input type="checkbox"/> Novice A <input type="checkbox"/> Novice B <input type="checkbox"/> Advanced <input type="checkbox"/> Excellent <input type="checkbox"/> Master	<input type="checkbox"/> Detective
Trial 2 Saturday 06/11/2022	<input type="checkbox"/> Novice A <input type="checkbox"/> Novice B <input type="checkbox"/> Advanced <input type="checkbox"/> Excellent <input type="checkbox"/> Master	<input type="checkbox"/> Novice A <input type="checkbox"/> Novice B <input type="checkbox"/> Advanced <input type="checkbox"/> Excellent <input type="checkbox"/> Master	<input type="checkbox"/> Novice A <input type="checkbox"/> Novice B <input type="checkbox"/> Advanced <input type="checkbox"/> Excellent <input type="checkbox"/> Master	<input type="checkbox"/> Novice A <input type="checkbox"/> Novice B <input type="checkbox"/> Advanced <input type="checkbox"/> Excellent <input type="checkbox"/> Master	
Trial 1 Sunday 06/12/2022	<input type="checkbox"/> Novice A <input type="checkbox"/> Novice B <input type="checkbox"/> Advanced <input type="checkbox"/> Excellent <input type="checkbox"/> Master	<input type="checkbox"/> Novice A <input type="checkbox"/> Novice B <input type="checkbox"/> Advanced <input type="checkbox"/> Excellent <input type="checkbox"/> Master	<input type="checkbox"/> Novice A <input type="checkbox"/> Novice B <input type="checkbox"/> Advanced <input type="checkbox"/> Excellent <input type="checkbox"/> Master	<input type="checkbox"/> Novice A <input type="checkbox"/> Novice B <input type="checkbox"/> Advanced <input type="checkbox"/> Excellent <input type="checkbox"/> Master	<input type="checkbox"/> Detective
Trial 2 Sunday 06/12/2022	<input type="checkbox"/> Novice A <input type="checkbox"/> Novice B <input type="checkbox"/> Advanced <input type="checkbox"/> Excellent <input type="checkbox"/> Master	<input type="checkbox"/> Novice A <input type="checkbox"/> Novice B <input type="checkbox"/> Advanced <input type="checkbox"/> Excellent <input type="checkbox"/> Master	<input type="checkbox"/> Novice A <input type="checkbox"/> Novice B <input type="checkbox"/> Advanced <input type="checkbox"/> Excellent <input type="checkbox"/> Master	<input type="checkbox"/> Novice A <input type="checkbox"/> Novice B <input type="checkbox"/> Advanced <input type="checkbox"/> Excellent <input type="checkbox"/> Master	

of classes entered above: _____ x \$25.00 = \$ _____
 # of Detective classes entered: _____ x \$35.00 = \$ _____
 Total Due: \$ _____

Make checks payable to: GSDCMSP

Mail to: Love That Dog, LLC 14151 Vale Court, Eden Prairie, MN 55346-3019

Event Secretary will add a \$35.00 collection fee to the amount of each returned check.

AKC Registered Name		Registration Number	
		<input type="checkbox"/> AKC/PAL/ILP/CP <input type="checkbox"/> Foreign	
Call name	Date of birth	Sex	
Breed		Variety	
Breeder			
Sire			
Dam			
Owner			
Owner's Address			
City	State	Zip	
Telephone	Email		
Handler name (if different from owner):		Junior Handler # (if applicable):	

Be sure to fill out, sign and include the Agreement with your entry form and check.



AGREEMENT

I certify that I am the actual owner of the dog, or that I am the duly authorized agent of the actual owner whose name I have entered. In consideration of the acceptance of this entry, I (we) agree to abide by the rules and regulations of The American Kennel Club in effect at the time of this event, and any additional rules and regulations appearing in the premium list of this event and entry form and any decision made in accord with them. I (we) agree that the club holding this event has the right to refuse this entry for cause which the club shall deem sufficient. I (we) certify and represent that the dog entered is not a hazard to persons or other dogs. In consideration of the acceptance of this entry and of the holding of this event and of the opportunity to have the dog judged and to win prizes, ribbons, or trophies, I (we) agree to hold the AKC, the event-giving club, their members, directors, governors, officers, agents, superintendents or event secretary and the owner and/or lessor of the premises and any provider of services that are necessary to hold this event and any employees or volunteers of the aforementioned parties, and any AKC approved judge, judging at this event, harmless from any claim for loss or injury which may be alleged to have been caused directly or indirectly to any person or thing by the act of this dog while in or about the event premises or grounds or near any entrance thereto, and I (we) personally assume all responsibility and liability for any such claim; and I (we) further agree to hold the aforementioned parties harmless from any claim of loss, injury or damage to this dog.

Additionally, I (we) hereby assume the sole responsibility for and agree to indemnify, defend and save the aforementioned parties harmless from any and all loss and expense (including legal fees) by reason of the liability imposed by law upon any of the aforementioned parties for damage because of bodily injuries, including death at any time resulting therefrom, sustained by any person or persons, including myself (ourselves), or on account of damage to property, arising out of or in consequence of my (our) participation in this event, however such injuries, death or property damage may be caused, and whether or not the same may have been caused or may be alleged to have been caused by the negligence of the aforementioned parties or any of their employees, agents, or any other person. I (we) agree that the determination of whether the injury is serious shall be made by the event veterinarian and is binding on me (us). I (WE) AGREE THAT ANY CAUSE OF ACTION, CONTROVERSY OR CLAIM ARISING OUT OF OR RELATED TO THE ENTRY, EXHIBITION OR ATTENDANCE AT THE EVENT BETWEEN THE AKC AND THE EVENT-GIVING CLUB (UNLESS OTHERWISE STATED IN THIS PREMIUM LIST) AND MYSELF (OURSELVES) OR AS TO THE CONSTRUCTION, INTERPRETATION AND EFFECT OF THIS AGREEMENT SHALL BE SETTLED BY ARBITRATION PURSUANT TO THE APPLICABLE RULES OF THE AMERICAN ARBITRATION ASSOCIATION. HOWEVER, PRIOR TO ARBITRATION ALL APPLICABLE AKC BYLAWS, RULES, REGULATIONS, AND PROCEDURES MUST FIRST BE FOLLOWED AS SET FORTH IN THE AKC CHARTER AND BYLAWS, RULES, REGULATIONS, PUBLISHED POLICIES AND GUIDELINES.

SIGNATURE of owner or his agent duly authorized to make this entry.

X: _____

Phone #: _____

Email: _____

In case of Emergency:

Name: _____

Phone #: _____